

Warning! Buyer/user assumes all responsibility for safety and proper use not in accordance with the directions and safety labels. 



## LIGHT STAND MOUNT

- Stainless steel construction
- Adjustable from 59in to 79in
- For use on 20in or 24in wide aquariums
- Welded mounts that connect directly to the stand
- Mounting hardware included
- Wave Point 4 lamp hanging kit included



### IMPORTANT WARNING AND SAFEGUARDS

*Age Recommendation: 18 years or over. Not a toy. Not intended for use by children without direct adult supervision. As the user of this product, you are solely responsible for operating it in a manner that does not endanger yourself and others or result in damage to the product or the property of others.*

1

## PART LIST

1. 2 x Stand mounting bracket 33.5"
2. 2 x Adjustable extension 37.5"
3. 2 x Light mounting arm 28.25" x 10.65"
4. Set of Wave-point light hanging kit item 10374
5. 6 x 1.25" screws with nut
6. 8 x 1" screws

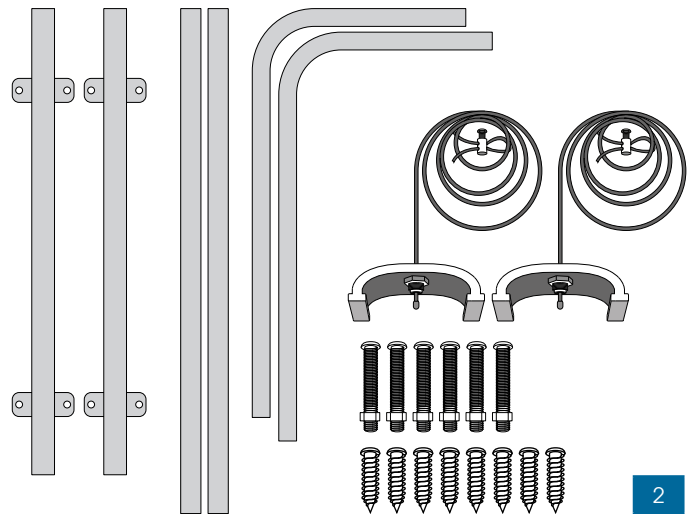

2

## INSTRUCTIONS FOR INSTALLATION

### Required tools for installation:

Level, Phillips screw driver and Small drill for pilot hole

### Instructions for installation:

1. Position the stand mounting brackets on the back of the stand. Make them equal distance from the edge of the stand and so that the light hanging kit is a minimum of 2" from the edge of the hood.
2. Now use the level to verify that they are straight. Depending on the stand design it may be necessary to install shims to level the unit.
3. Mark holes
4. Drill small pilot holes
5. Secure to with 1" screws stand
6. Slide the adjustable extension into the stand mount bracket and secure with the 1.25" screws and nuts
7. Slide the light mounting arm into the adjustable extension and secure with the 1.25" screws and nuts
8. Adjust height as needed

### Hanging light

9. Loosen the cable stop and remove from the cable
10. Slide the cable through the holes in the light mounting arm
11. Choose the desired height of the fixture
12. Cut wire to equal distances and secure with the cable stop
13. Slide mounting bracket onto the track of the light hood. Position them equal distance from the edge of the light hood. The bracket in the track should be a minimum of 2" from the edge of the light hood
14. Press down the button on the mounting bracket to level

If using other hanging kits follow their instructions and guidelines

3

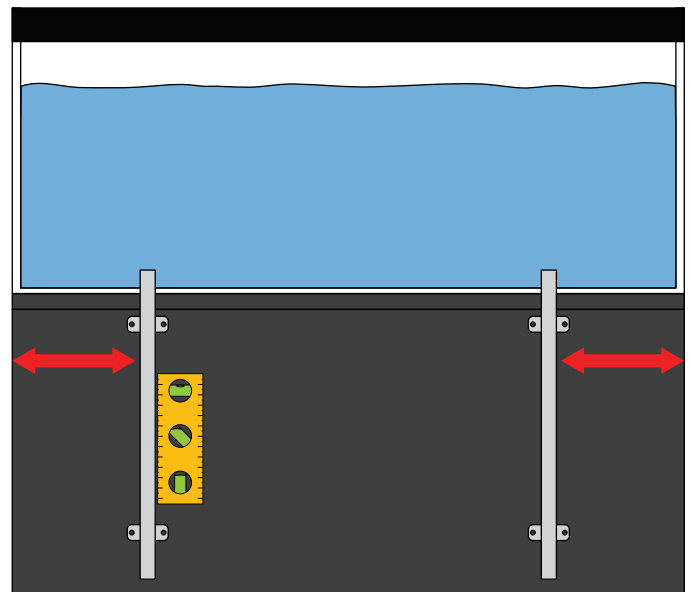

Wave Point® Technology

[www.wave-point.com](http://www.wave-point.com)

©2012 Wave Point® Technology

Photo: ©Wave Point®, ©Greg Rothchilds

All rights reserved

Specifications are subject to change without notice

4

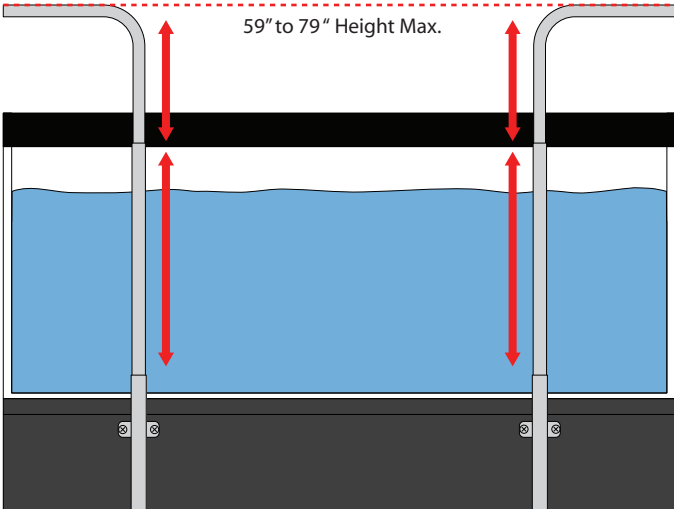
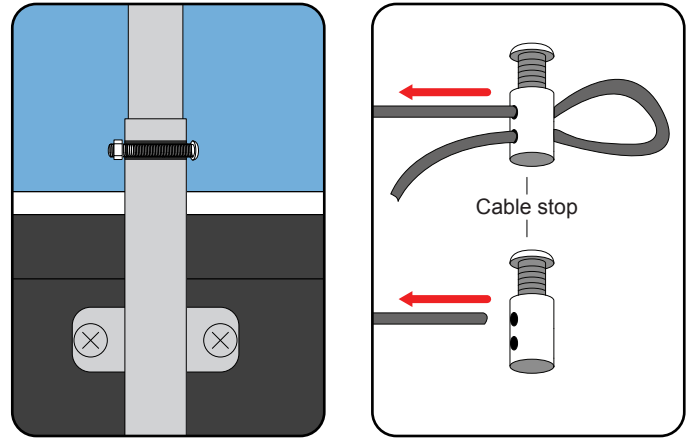
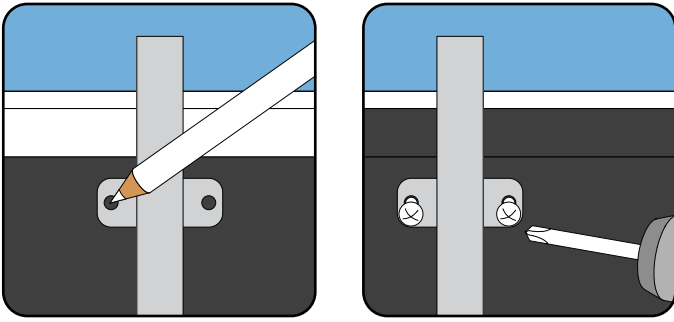

5

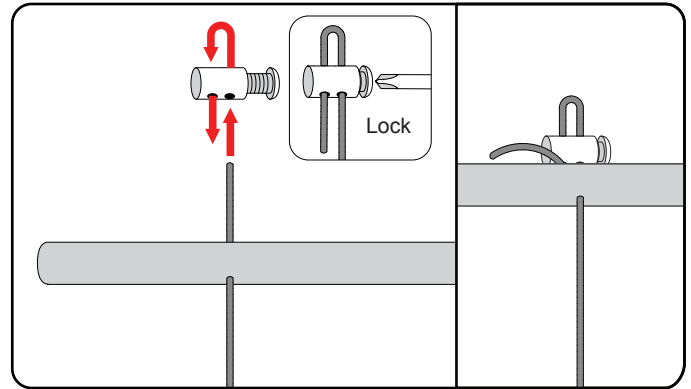

6

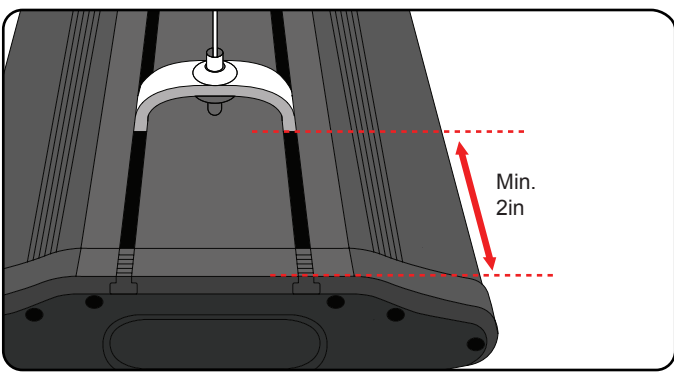
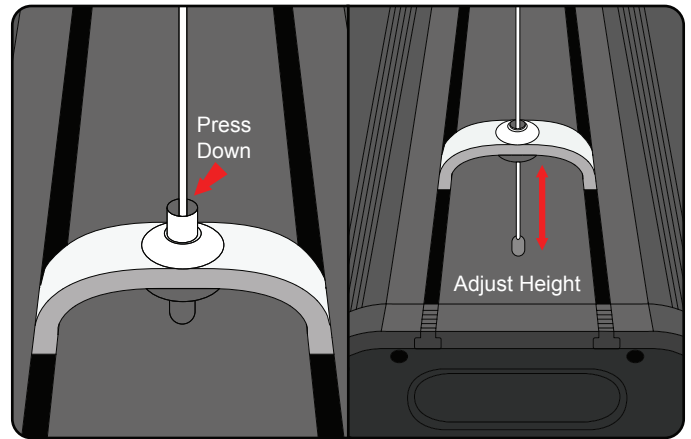
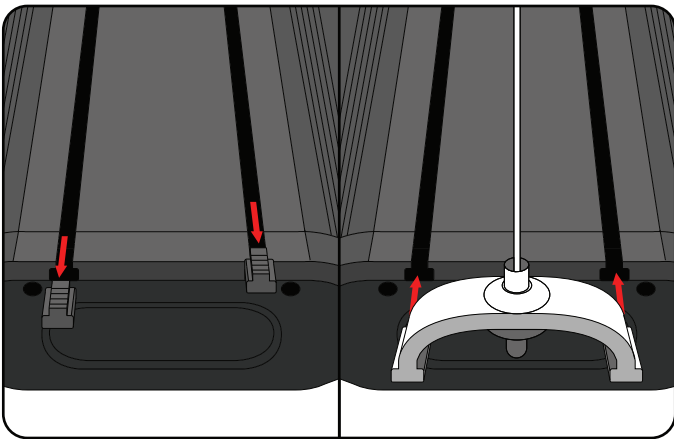

7

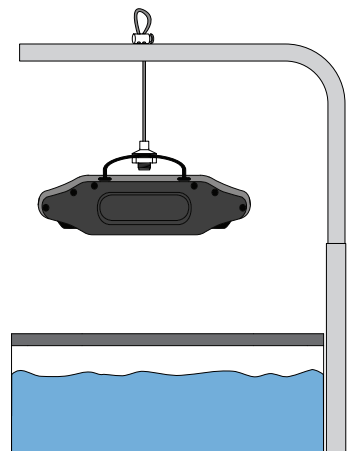

8